

ANSI 78
LMR-122D

ROCOF (df/dt)

4921240220B

DIN 35

LMR-122D
DEIF,

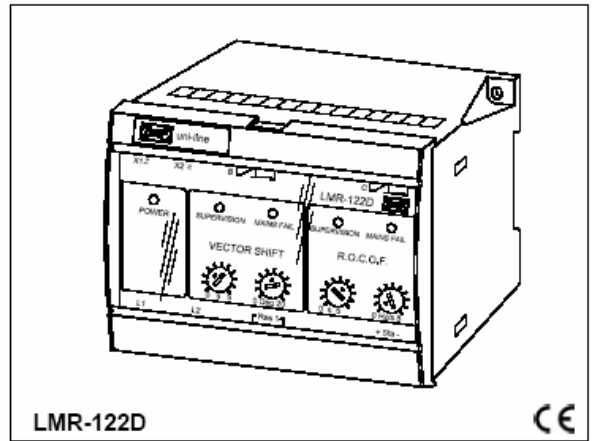

LMR-122D

1

2-

RESET (22-23)
LMR-122D

, LMR-122D

(2)

MAINS FAIL (

LMR-122D

G59.

(

LMR-122D

SUPERVISION

()

LMR-122D

30

100

ROCOF (df/dt).

ROCOF (Rate of change of frequency -
- df/dt)

29-30)

OFF ()

100 (

MAINS FAIL ()

LMR-122D

B: Vector shift () C: ROCOF (df/dt),

4- 5-

30 (

MAINS FAIL (

)

200

(U_n)

1,2 x U_n

2 x U_n 10

2 /

40 ... 45 ... 65 ... 70

“RESET” 18 ... 250

“Activated” () : 100

2

B + C (NE) (ND)

250 -8 -2000 ()

24 -8 -200 ()

(200 x 10³)

250 ()

150 ()

ROCOF (df/dt) <100

Vector Shift () <30

OFF () System status ()

- 25 ... + 70°C ()

±0.2% 10°C

3250 - 50 1

(U_n) 57,7-63,5-100-110-127-200-220-230-240-380-400-415-440-450-660-690 ±20% (4)

24-48-110-220 -25/+30% (3,5)

HSE, DIN 40040

EN 50081-1/2, EN 50082-1/2, SS4361503 (PL4) 255-3.

.4 2 ()

.2,5 2 ()

UL94 (V1).

: IP40. : IP20,

529 EN 60529

	/
(2 ... 20)	FAIL (MAINS)
ROCOF (df/dt) (0,3 ... 5 /)	FAIL (MAINS)
(0,5 ... 5)	SUPERVISION ()

POWER ()

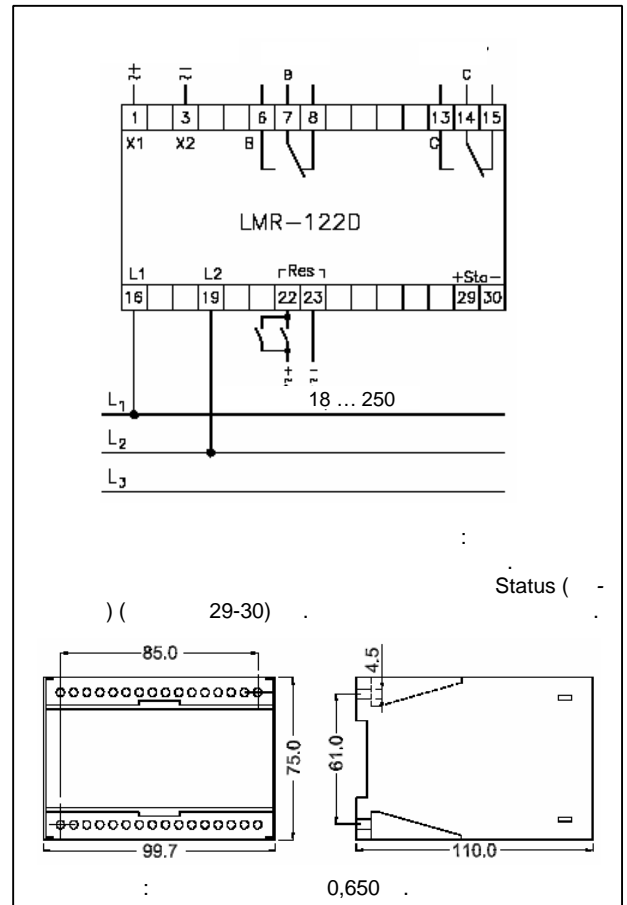

B - C -

LMR-122D - 380V AC - NE - NE - 24V DC